

# GUBB, GUBBD and GUBBM Cast Junction Boxes

## Explosionproof, Dust-Ignitionproof

UNILETS® for Use with Threaded Metal Conduit.

### GUBB

Class I, Division 1 and 2, Groups B, C, D  
Class II, Division 1 and 2, Groups E, F, G  
Class III  
NEMA 3, 3R, 4, 7BCD, 9EFG

### GUBBD

Class I, Division 1 and 2, Group D  
Class II, Division 1 and 2, Groups E, F, G  
Class III  
NEMA 3, 3R, 4

### GUBBM

Class I, Division 1 and 2, Group D  
Class II, Division 1 and 2, Groups E, F, G  
Class III  
NEMA 3, 3R, 4

## Applications

- Explosionproof and dust-ignitionproof, for use in classified locations.
- Corrosion-resistant: ideal indoors or outdoors.
- Junction or pull box for pulling and splicing of wires and as an enclosure for electrical devices.
- Ideal where number and size of conductors require a junction box with additional space.

## Features

- All GUBB/GUBBD/GUBBM Series Boxes
  - Provided with mounting lugs.
  - Furnished with covers.
  - All conduit hubs and openings provide a minimum of five full threads to meet UL requirements.
  - Accurately tapped, tapered conduit threads provide tight, rigid joints and ground continuity.
- GUBB Series
  - Wide selection of sizes and locations for drilled and tapped conduit openings.
  - Suitable for use as an enclosure for relays, instrument and other control apparatus in classified locations.
  - Available in high tensile strength malleable iron or copperfree aluminum bodies.
  - Provided with mounting lugs.
  - O-Rings standard for forms 1, 2 and 3 to provide raintight fit.
- GUBBD Series (Dome and Plate)
  - GUBB junction boxes with dome cover and mounting plate provide flexibility for a wide variety of applications.
  - Ideal for housing relays, contactors, terminal blocks and other classified area applications.
  - Mounting plate can be drilled to accommodate a variety of devices.
  - Dome cover has nominal depth of 6"/152mm or 17"/431mm, depending upon box selected. Provides significant increase in cubic inch capacity.
  - O-Rings standard to provide raintight fit.
  - Provided with mounting lugs.
- GUBBM Series (Instrument)
  - GUBBM junction boxes serve as an enclosure for meters, gauges and similar devices.
  - Complete with round, explosionproof glass window cover. Permits direct reading of enclosed instrument.
  - Furnished with one 3/4" drilled and tapped entry.
  - Mounted bosses provided in back of GUBBM can be drilled and tapped for fastening of instrument mounting bracket.
  - O-Rings standard to provide raintight fit.
  - Provided with mounting lugs.

## Standard Materials

- GUBB bodies: copperfree (4/10 of 1% max.) aluminum or malleable iron bodies
- GUBBD bodies: malleable iron bodies
- GUBB, GUBBD covers: copperfree (4/10 of 1% max.) aluminum
- GUBBM bodies: copperfree (4/10 of 1% max.) aluminum
- GUBBM covers: copperfree (4/10 of 1% max.) aluminum and glass
- O-Ring: neoprene



GUBB



GUBBM  
Instrument Box



GUBBD  
Dome Cover

## Standard Finishes

- GUBB malleable iron bodies: triple-coat — (1) zinc electroplate, (2) chromate, and (3) epoxy powder coat.
- GUBB aluminum covers and aluminum bodies: epoxy powder coat

## Options

- GUBB
  - Less cover, add suffix —**LC**.
  - Terminal blocks. Information provided upon request.
- Instrument mounting plate and bracket for GUBBM. Information provided upon request (submit complete dimensions of instrument to be used).

## Certifications and Compliances

- UL Standard: UL 886 (UL 1203)
- UL Listed: E10444
- CSA Standard: C22.2 No. 25, C22.2 No. 30
- CSA Certified: 025875

# GUBB Cast Junction Boxes for Drilling and Tapping Blank Body Ordering Information

## Explosionproof, Dust-Ignitionproof

Class I, Division 1 and 2, Groups B, C, D  
 Class II, Division 1 and 2, Groups E, F, G  
 Class III  
 NEMA 3, 3R, 4, 7BCD, 9EFG

Determine catalog number as follows: (1) select GUBB junction box catalog number; (2) select "Conduit Opening Arrangement Diagram" number; and (3) select symbols that represent conduit opening sizes from "Symbol Table."

Where no opening is required, the symbol 0 must be inserted. Add suffix for other Optional Features. The various divisions of the complete catalog number should be separated by dashes.

### Example

The junction box selected is GUBB-33 and the "Conduit Opening Arrangement Diagram" is diagram #1. Opening "a" is to be 3/4", "b", no opening required; "c", 2"; and "d", 1-1/4".

In this example, the complete catalog number is **GUBB-33-1-B0FD**  
 Standard Conduit Opening Arrangement Diagrams  
 Opening "a" is always TOP of box

If a "Standard Conduit Opening Arrangement" is not suitable for the application, or when openings are to be more accurately spaced, submit sketch, locating openings (1) from centerlines of box and (2) from outside back of box (or from mounting lug surface if lugs are supplied).

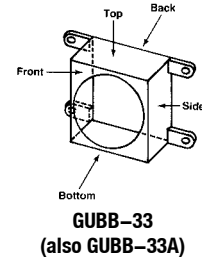
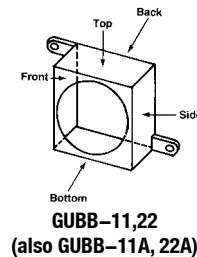

### Standard Conduit Opening Arrangement Diagrams

Opening "a" is always TOP of box. All conduit openings will be located in centerline of walls and evenly spaced unless otherwise specified.

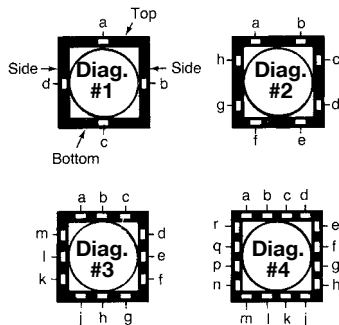

### Symbol Table

Drilling and Tapping (Five Threads Minimum)

Conduit Size Inches	Symbol	Conduit Size Inches	Symbol
0	Blank	-	-
1/2	A	2	F
3/4	B	2-1/2	G
1	C	3	H
1-1/4	D	3-1/2	J
1-1/2	E	4	K

Contact your local representative for drilling the back side of GUBB boxes.

### Minimum Recommended Spacing Between Conduit Openings

Allowance made for clearance over bushings. When unions or seals are used, additional space must be allowed.

Table shows minimum distances between conduit-opening centerlines in various size combinations. For example, if 1-1/2" and 3/4" openings are to be drilled and tapped into one side of box, the minimum spacing between centerlines would be 2.13".

Conduit Size Inches	Minimum Space Between Conduit Opening Centerlines in Inches/Millimeters									
	1/2	3/4	1	1-1/4	1-1/2	2	2-1/2	3	3-1/2	4
1/2	1.25/31.8									
3/4	1.38/35.1	1.50/38.1								
1	1.56/39.6	1.69/42.9	1.88/47.8							
1-1/4	1.88/47.8	2.00/50.8	2.19/55.6	2.44/62.0						
1-1/2	2.00/50.8	2.13/54.1	2.31/58.7	2.63/66.8	2.75/69.9					
2	2.38/60.5	2.50/63.5	2.69/68.3	2.94/74.7	3.13/79.5	3.44/87.4				
2-1/2	2.50/63.5	2.63/66.8	2.81/71.4	3.13/79.5	3.25/82.6	3.63/92.2	3.75/95.3			
3	2.88/73.2	3.00/76.2	3.19/81.0	3.44/87.4	3.63/92.2	3.94/100.1	4.13/104.9	4.44/112.8		
3-1/2	3.13/79.5	3.25/82.6	3.44/87.4	3.75/95.3	3.88/98.6	4.25/108.0	4.38/111.3	4.75/120.7	5.00/127.0	
4	3.44/87.4	3.56/90.4	3.75/95.3	4.06/103.1	4.19/106.4	4.56/115.8	4.69/119.1	5.06/128.5	5.31/134.9	5.63/143.0

# GUBB Cast Junction Boxes for Drilling and Tapping Blank Body Ordering Information

## Explosionproof, Dust-Ignitionproof

Class I, Division 1 and 2, Groups B, C, D  
 Class II, Division 1 and 2, Groups E, F, G  
 Class III  
 NEMA 3, 3R, 4, 7BCD, 9EFG

### Diameters of Bushings, Unions, Conduit and Seals (in Inches/Millimeters)

Conduit Size Inches	Diameters of fittings for 1/2 through 4" conduit									
	1/2	3/4	1	1-1/4	1-1/2	2	2-1/2	3	3-1/2	4
BBU Bushing	1.06/26.9	1.31/33.3	1.56/39.6	1.94/49.3	2.19/55.6	2.69/68.3	3.19/81.0	3.88/98.6	4.38/111.3	4.88/124.0
BU Bushing	1.13/28.7	1.25/31.8	1.63/41.4	2.06/52.3	2.31/58.7	2.94/74.7	3.25/82.6	3.88/98.6	4.56/115.8	5.06/128.5
UNY-UNF (R) Union	1.50/38.1	1.75/44.5	2.00/50.8	2.81/71.4	3.06/77.7	3.75/95.3	4.94/125.5	5.44/138.2	5.94/150.9	6.50/165.1
Conduit	0.88/22.4	1.06/26.9	1.38/35.1	1.69/42.9	1.94/49.3	2.38/60.5	2.88/73.2	3.50/88.9	4.00/101.6	4.50/114.3
EYM-EYF Seals T.R.†	1.06/26.9	1.19/30.2	1.38/35.1	1.75/44.5	2.06/52.3	2.31/58.7	2.69/68.3	3.13/79.5	3.44/87.4	3.69/93.7

### Wall Thickness and Maximum Conduit Size (in Inches/Millimeters)

Box Type	Top, Bottom and Sides		Back	
	Wall Thickness	Maximum Conduit Size	Wall Thickness	Maximum Conduit Size
GUBB-11, GUBB-11A	0.44/11.2	2	0.44/11.2	2
GUBB-22, GUBB-22A	0.44/11.2	2	0.63/16.0	4
GUBB-33, GUBB-33A	0.63/16.0	2	0.81/20.6	4

Enclosures and Junction Boxes

ENCLOSURES AND JUNCTION BOXES: HAZARDOUS JUNCTION BOXES

† T.R. is turning radius.

# GUBB Cast Junction Boxes for Drilling and Tapping

## Explosionproof, Dust-Ignitionproof

Drilled and tapped openings from 1/2" thru 4" as specified.

Class I, Division 1 and 2, Groups B♦, C♦, D  
 Class II, Division 1 and 2, Groups E, F, G  
 Class III  
 NEMA 3, 3R, 4, 7BCD, 9EFG

	Size LxWxD Inches/Millimeters	Cover Opening Inches/Millimeters	Form Number	Volume in <sup>3</sup> /dm <sup>3</sup>	Catalog Number	
					Malleable Iron ‡	Aluminum ‡
	7.00 x 6.50 x 6.75/ 177.8 x 165.1 x 171.5	5.38/136.7	1	120/ 2.0	GUBB-11	GUBB-11A
	10.00 x 8.00 x 6.88/ 254.0 x 203.2 x 174.8	7.19/182.6	2	224/ 3.7	GUBB-22	GUBB-22A
	12.00 x 12.00 x 7.75/ 304.8 x 304.8 x 196.9	9.69/246.1	3	455/ 7.5	GUBB-33	GUBB-33A

### Class I, Division 1 Sealing Requirements

Box	Group	Seals Required ♦
GUBB	B, C ♦	Yes
GUBB	D	No

Catalog Number	Mounting Lugs
GUBB-11, 11A	2
GUBB-22, 22A	2
GUBB-33, 33A	4

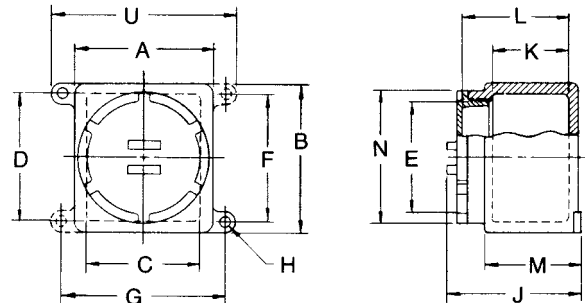

Catalog Number	Dimensions in Inches/Millimeters													
	A	B	C	D	E	F	G	H	J	K†	L	M	N	U
GUBB-11	6.50/	7.00/	5.50/	5.94/	5.38/	6.00/	7.75/	0.50/	6.75/	3.69/	5.25/	4.63/	6.25/	8.75/
GUBB-11A	165.1	177.8	139.7	150.9	163.7	152.4	196.9	12.7	171.5	93.7	133.4	117.6	158.8	222.3
GUBB-22	8.00/	10.00/	7.13/	9.00/	7.19/	9.00/	9.25/	0.50/	6.88/	3.50/	5.25/	4.63/	8.00/	10.25/
GUBB-22A	203.2	254.0	181.1	228.6	182.6	228.6	235.0	12.7	174.8	88.9	133.4	117.6	203.2	260.4
GUBB-33	12.00/	12.00/	10.75/	10.75/	9.69/	10.00/	13.13/	0.63/	7.75/	3.94/	5.75/	5.38/	11.00/	14.38/
GUBB-33A	304.8	304.8	273.1	273.1	246.1	254.0	333.5	16.0	196.9	100.0	146.1	136.7	279.4	365.3

‡ Malleable iron and aluminum boxes furnished with aluminum cover.  
 † Inside dimensions.



♦ Sealing fitting must be installed within 2" of each conduit entrance (max. conduit for Group B and C is 2"). Seals not required in Class I, Division 2 areas provided there are no arcing or sparking devices in the box.

# GUBBM Instrument Enclosures

## Explosionproof, Dust-Ignitionproof

GUBBM: Furnished with one 3/4" threaded conduit opening. Aluminum body with aluminum/glass cover.

Class I, Division 1 and 2, Group D  
 Class II, Division 1 and 2, Groups E, F, G  
 Class III  
 NEMA 3, 3R, 4

	Type Box	Conduit Opening Size (Inches-NPT)	Cover Opening Inches/Millimeters	Wall Thickness Inches/Millimeters	Form Number	Catalog Number
	GUBB-11A	3/4	5.38/136.7	0.44/11.2	1	<b>GUBBM-1A</b>
	GUBB-22A	3/4	7.19/182.6	0.44/11.2	2	<b>GUBBM-2A</b>
	GUBB-33A	3/4	9.69/246.1	0.56/14.2	3	<b>GUBBM-3A</b>

Other drilled and tapped conduit opening arrangements and sizes available in addition to the one 3/4" conduit opening provided.

GUBB Cast Junction Boxes for Drilling and Tapping Blank Body Ordering Information  
 For Covers and Mounting Plates, Order from GUBB Surface and Special Purpose Covers page.

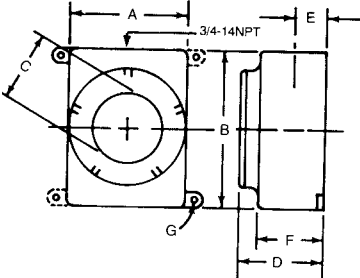
	Type Box	Mounting Lugs	Dimensions in Inches/Millimeters						
			A	B	C	D	E	F	G
	GUBBM-1A	2	6.50/ 165.1	7.00/ 177.8	3.13/ 79.5	5.63/ 143.0	2.06/ 52.3	4.63/ 117.6	0.50/ 12.7
	GUBBM-2A	2	8.00/ 203.2	10.00/ 254.0	4.75/ 120.7	5.63/ 143.0	2.06/ 52.3	4.63/ 117.6	0.50/ 12.7
	GUBBM-3A	4	12.00/ 304.8	12.00/ 304.8	6.88/ 174.8	8.94/ 227.1	3.50/ 88.9	5.38/ 136.7	0.63/ 16.0

# GUBBD Cast Boxes for Drilling and Tapping With Dome Cover and Mounting Plate

## Explosionproof, Dust-Ignitionproof

Malleable iron junction boxes furnished with aluminum cover.

Class I, Division 1 and 2, Group D  
 Class II, Division 1 and 2, Groups E, F, G  
 Class III  
 NEMA 3, 3R, 4

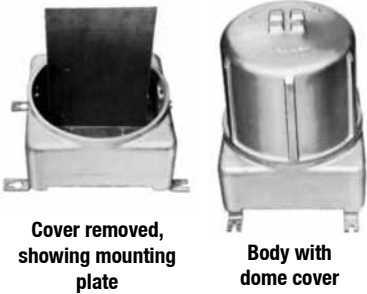
		Nominal Cover Depth Inches/Millimeters	Width of Mounting Plate Inches/Millimeters	Adjustment Inches/Millimeters †	Form Number	Catalog Number
 <p>Cover removed, showing mounting plate</p> <p>Body with dome cover</p>		10.00/254.0	3.50/88.9	1.00/25.4	1	GUBBD-1-10
		6.00/152.4				
		12.00/304.8	4.88/124.0	1.50/38.1	2	GUBBD-2-6
		6.00/152.4				
		12.00/304.8	6.25/158.8	2.13/54.1	3	GUBBD-3-6
		17.00/431.8				

### Dimensions

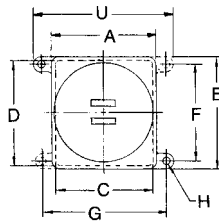

GUBBD-1 (2 Lugs), GUBBD-2 (2 Lugs), GUBBD-3 (4 Lugs)

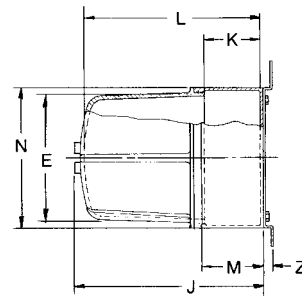

All Types

Catalog Number	Dimensions in Inches/Millimeters													
	A	B	C‡	D‡	E	F	G	H	J	K‡	L‡	M	N	U
GUBBD-1-10	6.50/ 165.1	7.00/ 177.8	6.06/ 153.9	6.56/ 166.6	5.38/ 136.7	6.00/ 152.4	7.75/ 196.9	0.50/ 12.7	16.13/ 409.7	3.75/ 95.3	14.75/ 374.7	4.63/ 117.6	6.25/ 158.8	8.75/ 222.3
GUBBD-2-6	8.00/ 203.2	10.00/ 254.0	7.56/ 192.0	9.56/ 242.8	7.19/ 182.6	9.00/ 228.6	9.25/ 235.0	0.50/ 12.7	12.19/ 309.6	3.81/ 96.8	10.75/ 273.1	4.63/ 117.6	8.06/ 204.8	10.25/ 260.4
GUBBD-2-12	8.00/ 203.2	10.00/ 254.0	7.56/ 192.0	9.56/ 242.8	7.19/ 182.6	9.00/ 228.6	9.25/ 235.0	0.50/ 12.7	18.19/ 462.0	3.81/ 96.8	16.75/ 425.5	4.63/ 117.6	8.06/ 204.8	10.25/ 260.4
GUBBD-3-6	12.00/ 304.8	12.00/ 304.8	11.38/ 289.1	11.38/ 289.1	9.69/ 246.1	10.00/ 254.0	13.13/ 333.5	0.63/ 16.0	13.81/ 350.8	4.38/ 111.3	11.56/ 293.6	5.38/ 136.7	11.00/ 279.4	14.38/ 365.3
GUBBD-3-12	12.00/ 304.8	12.00/ 304.8	11.38/ 289.1	11.38/ 289.1	9.69/ 246.1	10.00/ 254.0	13.13/ 333.5	0.63/ 16.0	19.81/ 503.2	4.38/ 111.3	17.56/ 446.0	5.38/ 136.7	11.00/ 279.4	14.38/ 365.3
GUBBD-3-17	12.00/ 304.8	12.00/ 304.8	11.38/ 289.1	11.38/ 289.1	9.69/ 246.1	10.00/ 254.0	13.13/ 333.5	0.63/ 16.0	25.31/ 642.9	4.38/ 111.3	23.06/ 585.7	5.38/ 136.7	11.00/ 279.4	14.38/ 365.3



† Mounting plate is adjustable. May be centered or located to one side.  
 ‡ Inside dimensions.

# GUBB/GUBBD/GUBBM Cast Junction Box Surface and Special Purpose Covers

## Explosionproof, Dust-Ignitionproof

Covers provide raintight fit when used with O-rings. Available in malleable iron, aluminum, and aluminum/glass.

Class I, Division 1 and 2, Group D  
 Class II, Division 1 and 2, Groups E, F, G  
 Class III  
 NEMA 3, 3R, 4

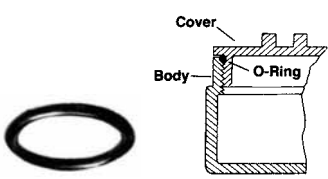
		Fits Box Catalog Number	Nominal Cover Depth Inches/ Millimeters	Nominal Cover Diameter Inches/ Millimeters	Window Diameter Inches/ Millimeters	Form Number	Catalog Number
<b>Covers — Aluminum — O-Ring Gasket Included</b>							
 <p>GUBK-1, GUBK-2      GUBK-3</p>	GUBB-11 (11A)		Surface	5.38/136.7	2.12/53.8	1	<b>GUBK-1</b>
	GUBB-22 (22A)		Surface	7.19/182.6	4.75/120.7	2	<b>GUBK-2</b>
	GUBB-33 (33A)		Surface	9.69/246.1	7.00/177.8	3	<b>GUBK-3</b>
<b>Instrument Box Covers — Aluminum and Glass</b>							
 <p>GUBMK-1, GUBMK-2      GUBMK-3</p>	GUBB-11 (11A)		—	5.38/136.7		1	<b>GUBMK-1</b>
	GUBB-22 (22A)		—	7.19/182.6		2	<b>GUBMK-2</b>
	GUBB-33 (33A)		—	9.69/246.1		3	<b>GUBMK-3</b>
<b>Dome Covers for GUBB Boxes — Aluminum — O-Ring Gasket Included</b>							
	GUBB-11 (11A)		10.00/254.0	5.38/136.7		1	<b>GUBK-1-10</b>
	GUBB-22 (22A)		6.00/152.4	7.19/182.6		2	<b>GUBK-2-6</b>
	GUBB-22 (22A)		12.00/304.8	7.19/182.6		2	<b>GUBK-2-12</b>
	GUBB-33 (33A)		6.00/152.4	9.69/246.1		3	<b>GUBK-3-6</b>
	GUBB-33 (33A)		12.00/304.8	9.69/246.1		3	<b>GUBK-3-12</b>
<b>Replacement O-Rings—Neoprene</b>							
 <p>Cover Body O-Ring</p>	Provide raintight fit for GUBB, GUBBM and GUBBD Boxes						
	GUBB-11 (11A)					1	<b>GUBG-1</b>
	GUBB-22 (22A)					2	<b>GUBG-2</b>
	GUBB-33 (33A)					3	<b>GUBG-3</b>
<b>Mounting Plates—0.13"/3.3mm Thick Aluminum. 4 standoffs, 4 mounting screws</b>							
	GUBB-11 (11A) *			4.50 x 4.50/ 114.3 x 114.3		1	<b>GUBBMP-11</b>
	GUBB-22 (22A) *			6.50 x 6.50/ 165.1 x 165.1		2	<b>GUBBMP-22</b>
	GUBB-33 (33A) *			9.00 x 9.00/ 228.6 x 228.6		3	<b>GUBBMP-33</b>

\* GUBB boxes are predrilled to accept a mounting plate.