

USE AND CARE GUIDE

240° MOTION ACTIVATED OUTDOOR INTEGRATED LED TWIN HEAD FLOOD LIGHT

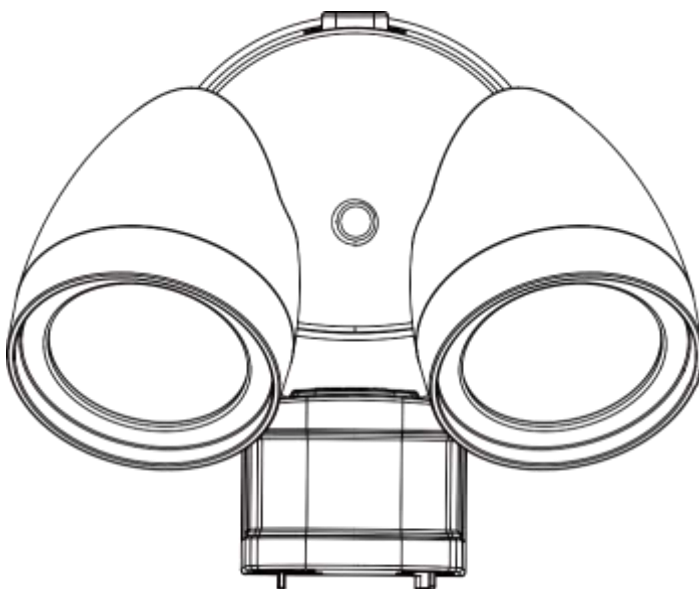

Questions, problems, missing parts? Before returning to the store,
call Commercial Electric Customer Service
8 a.m. - 7 p.m., EST, Monday - Friday
9 a.m. - 6 p.m., EST, Saturday

1-877-527-0313

HOMEDEPOT.COM

THANK YOU

We appreciate the trust and confidence you have placed in Commercial Electric through the purchase of this LED light. We strive to continually create quality products designed to enhance your home. Visit us online to see our full line of products available for your home improvement needs. Thank you for choosing Commercial Electric!

Table of Contents

Table of Contents.....	2	Package Contents.....	3
Safety Information	2	Hardware Included.....	3
Warranty	2	Installation	4
Pre-Installation	3	Light Distribution	7
Planning Installation.....	3	Care & Cleaning.....	9
Tools Required	3	Troubleshooting	9

Safety Information



WARNING: Carefully read and understand the information given in this manual before beginning the assembly and installation. Failure to do so could lead to electric shock, fire, or other injuries which could be hazardous or even fatal.



WARNING: Ensure the electricity to the wires you are working on is shut off. Either remove the fuse or turn off the circuit breaker.



WARNING: Changes or modifications not expressly approved by the party responsible for compliance could void the use authority to operate the equipment.

NOTICE: This equipment has been tested and found to comply with the limits for a Class B digital device, pursuant to Part 15 of the FCC Rules. These limits are designed to provide reasonable protection against harmful interference in a residential installation.

This equipment generates, uses and can radiate radio frequency energy and, if not installed and used in accordance with the instructions, may cause harmful interference to radio communications.

However, there is no guarantee that interference will not occur in a particular installation. If this equipment does cause harmful interference to radio or television reception, which can be determined by turning the equipment off and on, the user is encouraged to try to correct the interference by one or more of the following measures:

- ☐ Reorient or relocate the receiving antenna.
- ☐ Increase the separation between the equipment and the receiver.
- ☐ Connect the equipment into an outlet on a circuit different from that to which the receiver is connected.
- ☐ Consult the dealer or an experienced radio/TV technician for help.

FCC compliance information is listed as below:

Responsible party: Leedason America, Inc.

Responsible party address: 300 Technology Court SE Suite 100, Smyrna, GA 30082

Telephone number: (678) 293-8382

Warranty

WHAT IS COVERED

The manufacturer warrants this lighting fixture to be free from defects in materials and workmanship for a period of five (5) years from date of purchase. This warranty applies only to the original consumer purchaser and only to products used in normal use and service. If this product is found to be defective, the manufacturer's only obligation, and your exclusive remedy, is the repair or replacement of the product at the manufacturer's discretion, provided that the product has not been damaged through misuse, abuse, accident, modifications, alterations, neglect, or mishandling.

WHAT IS NOT COVERED

This warranty shall not apply to any product that is found to have been improperly installed, set-up, or used in any way not in accordance with the instructions supplied with the product. This warranty shall not apply to a failure of the product as a result of an accident, misuse, abuse, negligence, alteration, faulty installation, or any other failure not relating to faulty material or workmanship. This warranty shall not apply to the finish on any portion of the product, such as surface and/or weathering, as this is considered normal wear and tear.

The manufacturer does not warrant and specifically disclaims any warranty, whether express or implied, of fitness for a particular purpose, other than the warranty contained herein. The manufacturer specifically disclaims any liability and shall not be liable for any consequential or incidental loss or damage, including but not limited to any labor / expense costs involved in the replacement or repair of said product.

Contact the Customer Service Team at 1-877-527-0313 or visit www.HomeDepot.com

Pre-Installation

PLANNING INSTALLATION

Before beginning assembly, installation, or operation of the product, make sure all parts are present. Compare parts with package contents list and hardware contents list above. If any part is missing or damaged, do not attempt to assemble, install, or operate the product. Contact Customer Service for replacement parts.

This light fixture is suitable for wall mounting or eave mounting only. It is not suitable for ground mounting installation. The light fixture should be mounted a minimum of 6.5 ft. (2.0 m) above the ground. If two walls intersect, the distance between the intersecting line and the light fixture should be more than 2 ft. (0.6 m).



NOTE: Keep your receipt and these instructions for proof of purchase.

If you are unfamiliar with electrical installations, we recommend you contact a qualified electrician to do the installation.

TOOLS REQUIRED



Wire Strippers



Safety Goggles



Ladder



Silicone Sealant



Philips Screwdriver



Electrical Tape



Wire Cutters



Gloves

PACKAGE CONTENTS

Part	Description	Quantity
A	Light Head	2
B	Light Fixture Base	1
C	Motion Sensor	1



HARDWARE INCLUDED



NOTE: Hardware not shown to actual size.

Part	Description	Quantity
AA	Rubber Plug	1
BB	Mounting Screw	2
CC	Mounting Screw	2
DD	Wire Connector	3
EE	Mounting Screw(long)	1
FF	Mounting Bracket	1
GG	Foam Gasket	1

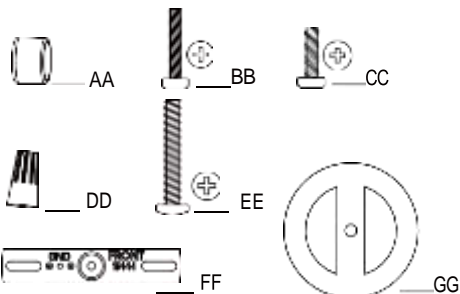

Installation

1 Determining the mounting location



NOTE: The light fixture should be mounted approximately 8 ft. (2.4 m) above the ground. If the light fixture is mounted higher than recommended, aiming the sensor down will reduce the coverage area.

- Determine the mounting location – wall or eave mount.
- Position the lamp heads (A) in the general direction of the desired light coverage.

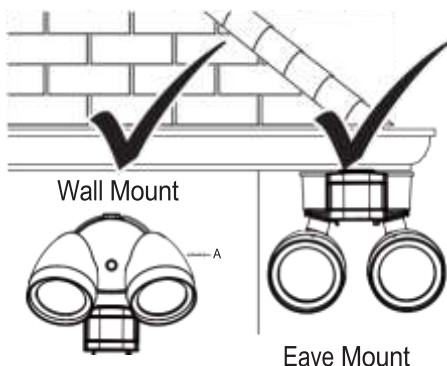

WARNING: RISK OF ELECTRIC SHOCK. Ensure the electricity to the wires you are working on is shut off. Either remove the fuse or turn off the circuit breaker before removing the existing light fixture or installing the new one.

With power disconnected to the electrical box, remove the existing fixture. Make a sketch of how the current fixture is wired (by wire color) or mark the wires with masking tape and a pencil so you will know how to properly reconnect the wires to the new LED light fixture.

2 Attaching the mounting bracket to the electrical box

- Install the mounting bracket (FF) with the stamped word "FRONT" facing away from the junction box. Use the mounting screws (BB or CC) that the best fit the junction box.
- Firmly pull on the mounting bracket (FF) to verify it is securely mounted to the junction box.

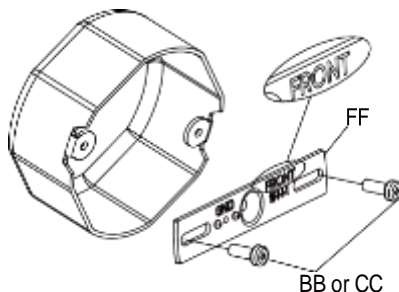

Installation (continued)

3 Attaching the foam gasket to the electrical box

- Position the foam gasket (GG) between the electrical box and the back of the light fixture base (B) to create a weathertight seal.
- Pull the wires from the electrical box through one of the two openings in the foam gasket (GG).

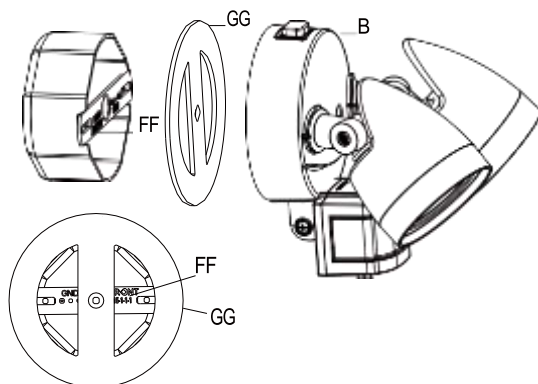

4 Making the electrical connections

- Connect the hot and neutral (black and white) wires from the light fixture base (B) to the same color wires from the electrical box.
- Connect the ground wire from the light fixture base (B) to the ground wire from the electrical box.
- Cover the wire connections using the wire connectors (DD).

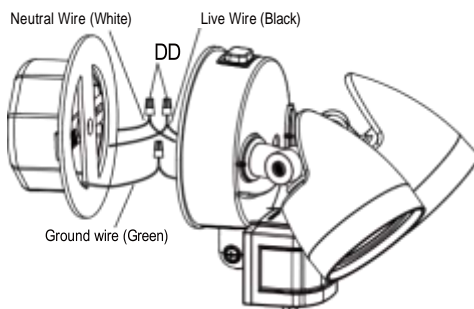

Installation (continued)

5 Attaching the light fixture to the mounting bracket

- Install the light fixture base (B) to the mounting bracket (FF) using the long mounting screw (EE) provided, making sure no wires are visible outside the light fixture.
- Insert the rubber plug (AA) into the hole on the light fixture base (B) for a finished appearance.

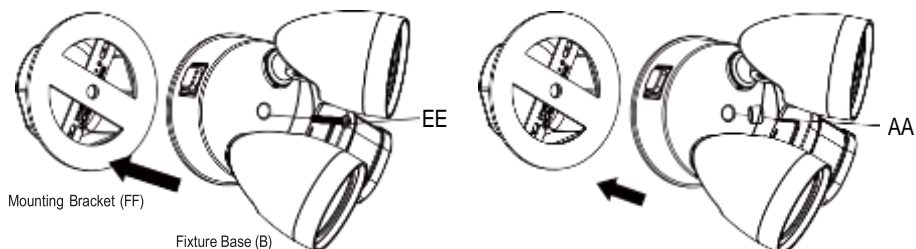

6 Sealing the light fixture

- Apply silicone sealant (not included) to the edges of the light fixture base (B) so that the fixture can be completely waterproof and dustproof.



NOTE: When attaching this light to an external, surface mount junction box, caulk around the inside of the light fixture before attaching to the light fixture.

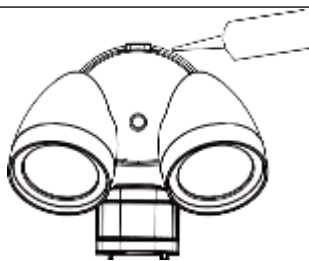

7 Adjusting the light heads and brightness

- Turn the power on at the circuit breaker or fuse and turn on the wall switch.
- Move each light head (A) into the desired position with your hand, as needed. This security light allows you to customize the brightness using 2 settings:
- H with 100% Brightness, L with 50% Brightness.
- Move the toggle switch at the bottom of the fixture to make your selection.

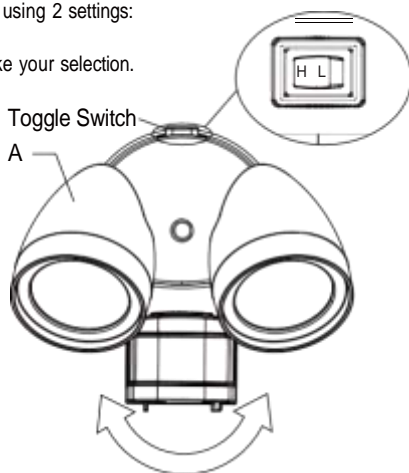
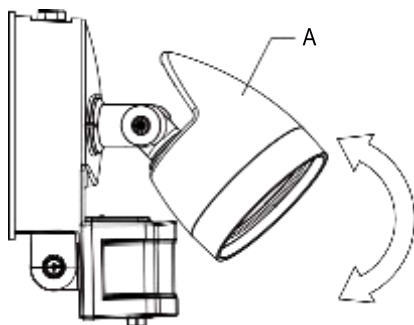

Operation

1 Setting the sensor for testing



NOTE: When the "Test / Timer" control is set to the "Test" position, the light fixture will operate during the day or night. The light will stay on for 5-8 seconds after all motion is stopped.

- Turn the "TIMER MINUTES" control to the "Test" position. And the indicator will flash 6 times.
- Turn the "SENSITIVITY" control to the position you want.



NOTE: The motion sensor will need to completely warm up (30 seconds) before beginning the setup process.

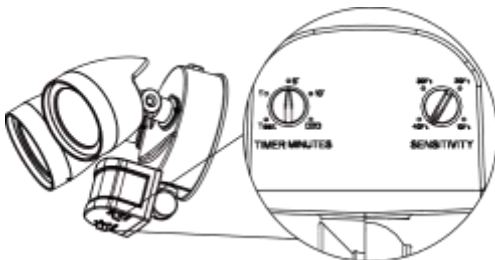

Operation (continued)

3 Adjusting the SENSITIVITY control

- To increase the sensitivity, turn the "SENSITIVITY" control counterclockwise.
- To decrease the sensitivity, turn the "SENSITIVITY" control clockwise.



NOTE: The motion sensor (C) is more sensitive to motion moving across the front of the sensor. The motion sensor (C) is less sensitive to motion moving directly toward the front of the sensor.



NOTE: The higher the "SENSITIVITY" setting, the greater the possibility of false triggering. To reduce false triggering, please choose the sensitivity you need.

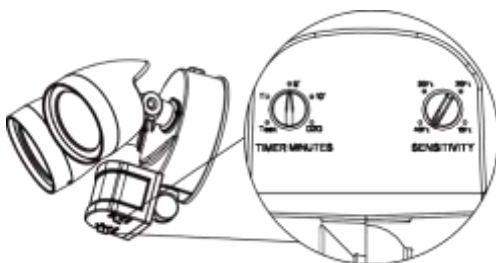

4 Adjusting the TIMER control



NOTE: The "TIMER MINUTES" control determines the amount of time the light will stay on full bright after all motion has stopped. And if you turn to "D2D" position, it will be a dusk to dawn (night time) light.

- Auto mode: After all adjustments are complete, turn the "TIMER MINUTES" control clockwise and select a time 1/5/10 minutes. The light will only work at night after a time has been selected.

- D2D mode: If you turn the "TIMER MINUTES" to "D2D" position, it will be a dusk to dawn (night time) light. The motion detection will be off, and the light will be always on at night, will turn off in the day time.

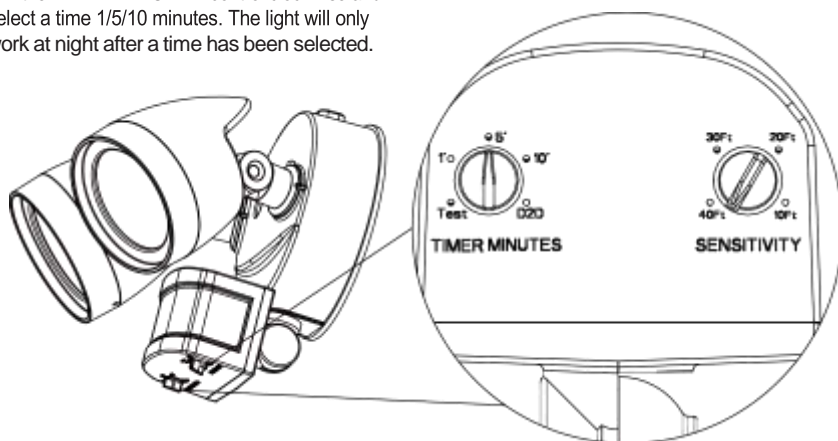

Care & Cleaning



CAUTION: Before attempting to clean the fixture, disconnect the power to the fixture by turning the breaker off or removing the fuse from the fuse box.

- Clean the fixture with a soft, dry cloth.
- Do not use cleaners with chemicals, solvents, or harsh abrasives.

Troubleshooting



WARNING: Before doing any work on the fixture, disconnect power to the light fixture.

Minor problems often can be fixed without the help of an electrician.

Problem	Possible Cause	Solution
The light will not come on.	<ul style="list-style-type: none">□ The light switch is turned off.□ The fuse is blown or the circuit breaker is turned off.□ Daylight turn-off (photocell) is in effect.□ The circuit wiring is incorrect (if this is a new installation).□ The motion sensor is aimed in the wrong direction.	<ul style="list-style-type: none">□ Turn the light switch on.□ Replace the fuse or turn the circuit breaker on.□ Recheck after dark.□ Verify the wiring is correct.□ Re-aim the motion sensor to cover the desired area.
The light comes on during the day.	<ul style="list-style-type: none">□ The motion sensor may be installed in a relatively dark location.□ The "Test / Timer" control is in the "Test" position.	<ul style="list-style-type: none">□ The light fixture is operating normally under these circumstances.□ Set the "TIMER MINUTES" control to a timed setting.
The light comes on for no apparent reason.	<ul style="list-style-type: none">□ The motion sensor may be sensing small animals, automobile traffic, or other heat sources.□ The "SENSITIVITY" control is set too high.□ The outside temperature is much warmer or cooler than a person's body heat (summer or winter).□ The light fixture is wired through a dimmer or timer.	<ul style="list-style-type: none">□ Decrease the "SENSITIVITY" setting or reposition the motion sensor.□ Decrease the "SENSITIVITY" setting.□ Decrease the "SENSITIVITY" setting.□ Do not use a dimmer or timer to control the light fixture. Replace the dimmer or timer with a standard on/ off wall switch.

Troubleshooting (continued)

Problem	Possible Cause	Solution
The lights stay on continuously.	<ul style="list-style-type: none"> □ The motion sensor may be picking up a heat source, such as an air vent, dryer vent, or brightly painted, heat-reflective surface. □ The light fixture is wired through a dimmer or timer. □ The light fixture is on the same circuit as a motor, transformer, or fluorescent bulb. 	<ul style="list-style-type: none"> □ Decrease the "SENSITIVITY" setting or reposition the motion sensor. □ Do not use a dimmer or timer to control the light fixture. Replace the dimmer or timer with a standard on/off wall switch. □ Install the light fixture on a circuit without motors, transformers, or fluorescent bulbs.
The lights flash on and off.	<ul style="list-style-type: none"> □ Heat or light from the bulbs may be turning the motion sensor on and off. □ Heat is being reflected from other objects and may be turning the motion sensor on and off. □ The motion sensor is in "TEST" mode and warming up. 	<ul style="list-style-type: none"> □ Reposition the lamp heads away from the motion sensor. □ Decrease the "SENSITIVITY" setting or reposition the motion sensor. □ While in "TEST" mode, the light only stays on for 5~8 seconds. Set the "TIMER MINUTES" control to a timed setting.

